

A solid purple square containing the text "Lakeland Arts Trust" in white, sans-serif font.

Lakeland
Arts Trust

A large, abstract, textured background image with muted colors of grey, blue, and yellow, resembling a painting or a textured surface.

Lakeland Arts Trust
Annual Review 2012

Legal & Administrative Information

Charity Number

526980

Principal Office

Abbot Hall, Kendal, Cumbria, LA9 5AL

Trustees

Martin Ainscough BSc DL
Elizabeth (Pit) Rink BSc MPhil
Henry C F Bowring MA JP DL
Anthea Case CBE BA FRSA
Michael Clarke CBE FRSE
Charles Crewdson OBE JP
Charlie Gere MA PhD
Annie Graham BA (to 9 November 2012)
Jocelyn M Holland MA
Sara Keegan
John Martin Robinson MA DPhil DLitt FSA
Peter B Rogers CBE BA (Econ) MSc
(to 16 November 2012)

Officers

Gordon B Watson BA AMA
Anthony R Collinson (Hon. Secretary)

Bankers

Barclays Bank plc,
9 Highgate, Kendal, Cumbria, LA9 4DF

Solicitors

JWK
5/7 Skipton Street, Morecambe, Lancashire, LA4 4AW

Investment Advisors

Sarasin & Partners LLP
Juxon House, 100 St Paul's Churchyard
London, EC4M 8BU

Auditors & Accountants

Stables Thompson & Briscoe
Lowther House, Lowther Street
Kendal, Cumbria, LA9 4DX



Contents

4	Introduction from Chairman and Chief Executive
6	Exhibitions
9	Artist commissions
10	Collections
12	Learning and Community Engagement
14	Volunteers
16	Development
18	Communication
19	Commercial Activities
20	Fundraising
22	Statement of Financial Activities

Front cover
JMW Turner. *A rainbow over a Swiss lake*, c.1841-45
© Sir Nicholas Bacon

Opposite
Sixth form sketching class at *Hughie O'Donoghue Vivid Field* exhibition
© Lakeland Arts Trust

Introduction

Opposite
Schools 'Take Over Day' at Abbot Hall
© Victoria Middleton Photography

2012 was an exciting and important year for the Lakeland Arts Trust. During the year we celebrated 50 years since the opening of Abbot Hall, took the new Steamboat Museum from initial concept through to detailed design and secured additional funding which will enable the Trust to develop with greater confidence over the next three years.

We are constantly reminded of the generosity of our supporters and partners. The highly successful opening exhibition at Abbot Hall *Turner and His Contemporaries: The Hickman Bacon Watercolour Collection* was thanks to the kindness of Sir Nicholas and Lady Bacon and their willingness to allow us to borrow works from the outstanding collection of British watercolours collected by Sir Hickman Bacon. We followed this with the *Abbot Hall at 50* exhibition which celebrated the collection built up since the Gallery's foundation by previous directors and including many works given by individual donors. Throughout the year our Friends, Patrons and Benefactors and many volunteers got closely involved in the Trust and supported us.

We were delighted that the Trust received many individual donations to the capital campaign for the Windermere Steamboat Museum and these helped us make a strong case for support in securing grants from the Regional Growth Fund and trusts and foundations, including grant offers from the Sir John Fisher Foundation, The Wolfson Foundation, Garfield Weston Foundation and the JP Getty Jnr Charitable Trust.

The Lakeland Arts Trust generates most of its income through its activities and private fundraising. We also secured additional public support from April 2012 with significant increases in funding from Arts Council

England as a National Portfolio Organisation and Major Partner Museum. The latter is in a new partnership with the Wordsworth Trust and Tullie House Museum and Art Gallery and we look forward to working closely with both organisations as the Cumbria Museum Consortium.

2012 was an important year for the long-term future of the Lakeland Arts Trust. Successful development of the Steamboat Museum will strengthen the Trust by creating a purpose-built facility on a wonderful site beside Windermere; it will develop and increase our audience and transform public access to the nationally significant collection of boats which are all associated with Windermere. We also started planning the development of Abbot Hall and we are excited by the initial designs to improve the galleries and other spaces on site to create a much better experience for visitors and enable us to show more of the collections and develop exhibitions and learning activities. Building improvements are subject to funding and securing this will be a future priority so that Abbot Hall continues to be one of the leading galleries outside London and the collections can be enjoyed by many more visitors.

There is no better time to support the Trust as new donations are currently matched pound for pound through two schemes: Arts Council England Catalyst for the Trust as a whole and Heritage Lottery Fund Catalyst Endowment for the Steamboat Museum. We are seeking to raise £500,000 for the latter to create a £1m endowment. Legacies are a great way of making a lasting impact and helping build the future of the Lakeland Arts Trust so that the Trust can carry on delighting thousands of visitors each year and caring for and developing the permanent collections and nationally important historic buildings.

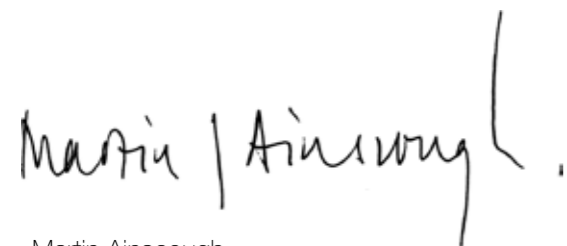

Martin Ainscough
Chairman

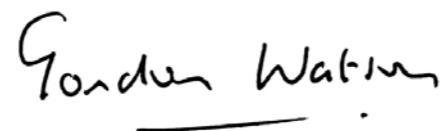

Gordon Watson
Chief Executive



Exhibitions

2012 marked the fiftieth anniversary of the opening of Abbot Hall Art Gallery on 28 September 1962. We celebrated this with a series of major exhibitions which attracted a record number of visitors to the Gallery. Included in this was a display about the early days of the Gallery and the remarkable series of events that led to local people forming our Trust in 1957 to save Abbot Hall and convert it into an art gallery.

The first exhibition of the year was *Turner and His Contemporaries: The Hickman Bacon Watercolour Collection*. Thanks to the generosity of Sir Nicholas and Lady Bacon we were able to show more than 40 outstanding works from the magnificent collection assembled by Sir Hickman Bacon almost one hundred years ago, representing one of the most important private holdings of British eighteenth and nineteenth century watercolours in the world. The show included the greatest watercolourists of the period including JMW Turner, Thomas Girtin, John Robert Cozens and John Sell Cotman.

We followed this with *Abbot Hall at Fifty*, an exhibition of works from the Trust's collection. Over 90 people nominated works for the exhibition and wrote short statements explaining their choices which we included with the exhibition labels. The exhibition showed the quality of our collection and the important contribution of past directors, trustees and many donors and funders in developing the collection over the past 50 plus years. We were delighted that Mary Burkett OBE, the Trust's director from 1966 to 1986 was able to open the exhibition.

The summer show at Abbot Hall was *Francis Bacon to Paula Rego*. We worked with Robert Priseman to develop the exhibition which featured important loans and new works. The exhibition would not have been possible without the very significant support of the Arts Council Collection, South Bank Centre, London, Tate, British Council Collection, Scottish National Gallery of Modern Art, Hatton Gallery, Newcastle University (Tyne & Wear Archives & Museums) as well as private lenders and funding from Arts Council England, South Lakeland District Council and the Cultural Olympiad, Sir John

Opposite
Halima Cassell. *Cell Stem, Roundelay and Stelliform*, 2010. Blackwell
© Tony West photography

Below
Turner and His Contemporaries private view. Abbot Hall
© Lakeland Arts Trust

Fisher Foundation and sponsorship from Rathbones Investment Management. We were particularly pleased that this support allowed us to include major works in the show; for many visitors the highlights were the three works by Francis Bacon: *Head VI*, 1949, *Study for a Figure VI*, 1956-7 and *Two Figures*, 1975.

Hughie O'Donoghue is one of the most exciting artists working in the UK today and we ended the year with his exhibition *Vivid Field: Selected Paintings & Drawings* 1984-2012. The exhibition featured many new works and we selected *A Moment's Liberty I*, 2012, as the work we aim to acquire for the collection. O'Donoghue opened the exhibition, gave a wonderful talk on his work and did a walking tour of the exhibition with many of our volunteer invigilators on the day the exhibition opened.



Opposite
Laura Ellen Bacon. *Exposed: A Sculptural Installation at Blackwell*
© Tony West photography

Helen Petts at Kurt Schwitters's Merzbarn in the Lake District.
© Helen Petts

Below
Robert Priseman. *Omagh 15:00, 2010*
© Robert Priseman

The leading exhibition at Blackwell in 2012 was *Light Structures: Halima Cassell*. The exhibition reflected the extensive research on Blackwell that Halima Cassell did over the previous two years and also included work she created in response to the house, as well as showing earlier pieces, many of which were lent to the show by private owners. The exhibition was throughout the house which created interesting juxtapositions of the geometric decoration of the works against the period Arts & Crafts decoration of Blackwell and the ever changing qualities of Blackwell's light filled rooms.

Other exhibitions at Blackwell in 2012 included:

- *Stanley Webb Davies (1894-1978)*
- *Woven from Nature: Four Contemporary Makers*
Showing work by established makers Mary Butcher and Jilly Edwards and their nominees Maggie Smith and Jo McDonald
- *From Rossetti to Voysey: Arts & Crafts Stamped Cloth Book Cover Design*
- *Arts & Crafts Enamel: Lydia Cooke*



Artist Commissions

The Trust is very interested in working with artists and we regularly involve artists as creative practitioners in our learning and engagement programmes. In 2012 we commissioned Laura Ellen Bacon to create *Exposed: A Sculptural Installation at Blackwell*. We produced a short film of Laura Ellen Bacon talking about her work and published this on our website and YouTube. We also commissioned Halima Cassell to research Blackwell's history, architecture and collection and create new work in response to her research. In her resulting show she produced work in several new mediums including stone, porcelain and glass. At Abbot Hall in the autumn we showed Helen Petts's new film about Kurt Schwitters 'Throw them up & let them sing'.



Collections

Below
Paula Rego. *Triptych*, 1998
© Lakeland Arts Trust

We thank the Contemporary Art Society for enabling the Trust to acquire two works by Keith Vaughan: *The Bather*, 1960, oil on board and *Three Figures*, 1960-1, oil on board. The Trust received two generous gifts into the collection. Alison Morton, daughter of Alistair Morton, donated an unfinished painting of her father, *Unfinished Portrait of Alistair Morton*, 1962 by Claude Harrison and GJ Gittings donated a framed print of a Baillie Scott interior.

The V & A Purchase Grant Fund and Arts Council England contributed to the purchase of *Seated Madonna*, 2006 by Philip Eglin. In addition we purchased two dining chairs designed by MH Baillie Scott for display in Blackwell, Baillie Scott's greatest house. The chairs have his characteristic harebell design in the chair splat and were probably designed for JP White, The Pyghtle Works, Bedford.

In 2012 we completed the purchase of the Rolls Royce Hawk engine which was installed in MV Canfly 1922 by its original owner Major EH Pattinson. The seven-litre engine was made in 1917 to power a Royal Naval Air Service airship. The purchase was supported by the Prism Fund and individual donors and ensures the engine and boat can be displayed together in the new Windermere Steamboat Museum.

All of the oil paintings in the Lakeland Arts Trust collection were added to the *Your Paintings* website in 2012, which the Public Catalogue Foundation has developed in partnership with the BBC to make 210,000 images of paintings in UK collections available on line.

Joseph Hardman's photographs are a very evocative record of the people and places of the Lake District. In recording everyday life in the 1930s to the 1960s he captured rural traditions, ways of farming and leisure activities that have since disappeared or changed. Thanks to the support of the Gannett Foundation, we have made digital copies of the negatives and around 5,000 images are available on the Trust's website. Anyone can now browse and search the collection and purchase copies.

Works owned by the Trust are often requested for exhibitions in other museums and galleries. In 2012 we were pleased to lend the following works:

A Cumbrian Artist Rediscovered: John Smith

12 November 2011 - 15 April 2012

Wordsworth Trust, Grasmere

- John 'Warwick' Smith
Loading Slate, Coniston, 1791

Paula Rego

26 January - 30 March 2012

Fundacao Calouste Gulbenkian, Paris

- Paula Rego, *Triptych*, 1998

The Kendal Sketchbook

30 June - 8 September 2012

Kendal Museum, Kendal

- George Romney, *Study: The Death of General Wolfe at Quebec*, 1759
- George Romney, *Sketchbook*, c.1770

Towards Modernity: Three Centuries of British Art

21 September 2012 - 9 August 2013

Various venues in China c/o Bury Art Museum

- Frank Auerbach, *David Landau*, 2007
- Peter Lanyon, *The Yellow Runner*, 1946
- John Constable, *The Lower Cascade, Rydal*, 1806

David Hockney: A Rake's Progress

1 October - 14 December 2012

Peter Scott Gallery, Lancaster

- David Hockney, *A Rake's Progress*, 1961-3

Phillipe-Jacques de Louthembourg (1740 - 1812)

17 November 2012 - 18 February 2013

Musee des Beaux-Arts, Strasbourg

- Phillipe-Jacques de Louthembourg, *Belle Isle, Windermere in a Storm*, 1785
- Phillipe-Jacques de Louthembourg, *Belle Isle, Windermere in a Calm*, 1786



Over recent years we have shown more of our permanent collections in temporary displays, often exploring specific themes or periods. This enables visitors to see items that would otherwise be in store and, over time, creates public access to a broad range of works of art and museum objects. In 2012, the collection-based displays included:

At Abbot Hall Art Gallery

- **Edward Wilson: Artist of the Antarctic**
12 January - 21 April
- **Face to Face: Modern Portraits from Abbot Hall's Permanent Collection**
12 January - 26 March
- **'This Exciting Gallery': Abbot Hall's Early Years**
29 March - 28 May
- **John Ruskin: 'All Great Art is delicate'**
24 April - 30 June 2012
- **David Hockney: A Rake's Progress**
1 June - 9 September
- **Around the Lakes with Edward Lear**
4 July - 22 December
- **Work in Progress: Photographs of Abbot Hall's renovation 1960s**
1 August - 22 December
- **Keith Vaughan: Figures**
12 September - 22 December
- **Kurt Schwitters**
15 September - 22 December

At Blackwell, The Arts & Crafts House

- **A House for an Art Lover: MH Baillie Scott and Charles Rennie Mackintosh's Folios**
13 January - 29 April 2012
- **Abbot Hall at Blackwell**
19 October - 31 December 2012

At Museum of Lakeland Life & Industry

- **Something Old from Something New: Rag Rug Making**
23 January - 22 December
- **Mind Your p's & q's: Printmaking**
23 January - 9 July 2012
- **The Art of Lace**
16 July - 22 December

Abbot Hall Coffee House

- **Henry Herbert (1858-1928) Photographs**
12 January - 17 April
- **Joseph Hardman (1893-1972) Photographs**
18 April - 19 July
- **Joseph Hardman (1893-1972) Winter in the Lake District**
2 October - 22 December

Learning and Community Engagement

We were pleased in 2012 to continue the START programme funded by The Prince's Trust. This enabled us to work with Ryelands School and St Joseph's RC schools in Lancaster on projects directly related to our exhibitions and collections. Continuing on from the first year, teachers were equipped to lead self-guided explorations around Abbot Hall, and activities led by our creative practitioner focussed on a cross curricula approach to teaching. We also secured funding for a second year to continue the programme into 2013.

Pupils at Heron Hill produced a new trail for Abbot Hall Art Gallery in a similar format to the one they did for Blackwell in 2011. They chose what they liked about the Art Gallery and its collections, picking out detail within *The Great Picture* to allow further exploration of this popular painting. The *Trou Madame* bagatelle table provided a source of inspiration for a mathematical challenge, whilst George Romney's painting *The Gower Family* allows users of the trail to get musical. Hand drawn illustrations of the paintings animate the trail.

We started new work in 2012 with the surrounding communities, engaging them in a programme of activity that they may have felt excluded from in the past. A local group Well-Art started work within the learning space, the LAB, and the Art Gallery with our engagement officer. This art group offers practical workshops for adults with mental health issues. Working with the learning team the group aims to become self sufficient with funding to support the work they will continue to do on site. This enabled us to establish a space where community groups could be invited to work with the learning team at our various sites, and established outreach work with various groups. Both Young Cumbria and Grange nursing home engaged in our outreach programme, with both following it up with a visit to the Gallery and Museum. The initial work in 2012 will inform our future health and well being programmes.

We worked in partnership with other organisations in 2012 to host events. Many of these were new to our sites and others built on existing joint working. They included:

- Inspiration Day: Greenwood Woodwork Meets Design with Grizedale Arts at Blackwell
- The Allotment at Blackwell with Brewery Arts as part of the Freerange Comedy Festival
- Concerts at Blackwell and Abbot Hall during the Lake District Summer Music Festival in August
- The British Classic Boat Rally and the Steam Boat Association of Great Britain Windermere Rally visited the Windermere Steamboat Museum in the summer. Both events brought the colour, sound and smell of historic boats to the site and were blessed with fine weather.
- The annual Mintfest in Kendal was based in Abbot Hall park from 31 August to 2 September and many of the events took place in the courtyards of Abbot Hall. The Abbot Hall site proved to be an excellent venue for performance, music and other events included in Mintfest. During the weekend we ran a two day workshop called *Humazing*, where participants were encouraged by artist Sally Taylor to make large scale drawings of themselves. These were then filled in with simple mark making inspired by the *Francis Bacon to Paula Rego* exhibition, and then hung in a beguiling maze of bodies outside the Gallery.

Other events in our venues in 2012 included:

- A series of talks relating to British watercolours held during the *Turner and His Contemporaries* exhibition
- Talks and workshops on *The Great Picture* and Lady Anne Clifford
- Walking tours and talks given by exhibiting artists, or visiting experts including Halima Cassell, Laura Ellen Bacon, Hughie O'Donoghue, Helen Petts, Professor David Ingram and Paul Atterbury
- Heritage Open Day at the Windermere Steamboat Museum in September, giving visitors an opportunity to see the collections and the conservation of SL Osprey and hear more about our plans to transform and reopen the Museum.

The Trust played host to the 'in conversations' aspect of the Kendal Mountain Festival, with authors using the learning space as a place to converse with their readers. The Helen Petts video installation 'Throw them up and let them sing' was highlighted in the KMF programme as it drew on the landscape of Cumbria and Norway.

The National Campaign for Drawing month long celebration – The Big Draw – was extended to all of our venues, to encourage all visitors to draw, and be inspired by the buildings and collections. To complement this a postcard competition A.Non Artist, whereby visitors could leave an anonymous drawing about the venue, was installed at all sites; the participants created over 100 postcards.

Family workshops were run in school holidays by creative practitioners, enabling families to engage with the exhibitions and collections on display at all of our venues. These varied from *Light Images* exploring the light in JMW Turner's paintings to create a translucent window display, to carving soap inspired by Blackwell and the beautiful work of Halima Cassell.

Below
Humazing event at Abbot Hall
© Lakeland Arts Trust

Wood bending with Charlie Whinney
© Charlie Whinney

Allotment
© Nutshell Theatre



Volunteers

Bernard Rushton, conservation volunteer at Windermere Steamboat Museum
© Steve Barber

Jean Wood, volunteer invigilator at Abbot Hall Art Gallery
© Lakeland Arts Trust

Volunteers are an essential part of the Trust's operation and our ability to open up the collections and engage with visitors at Abbot Hall, Blackwell and the Windermere Steamboat Museum. Our volunteers recorded over 4000 volunteer hours in 2012 and we would like to thank them all for their commitment and support of our activities.

There are a vast range of opportunities to volunteer across the Trust, each role supporting a different aspect of the Trust's ambitions whether it is invigilating an exhibition at Abbot Hall, providing talks for group visits at Blackwell or assisting with research and conservation at the Windermere Steamboat Museum.

The Trust and our visitors benefit hugely from the 110 volunteer invigilators who support the ambitious exhibition programme at Abbot Hall. They enable us to mount high calibre shows such as *Turner and his Contemporaries* and *Francis Bacon to Paula Rego*, and to maintain the safety and security of the masterpieces on show and fulfil the strict requirements of UK Government Indemnity. Craft demonstrations led by volunteers at the Museum of Lakeland Life and Industry help bring the collection to life and create opportunities for visitors to learn about traditional skills through hands-on demonstrations.

Volunteers at the Windermere Steamboat Museum are helping to shape the future of the museum. Cataloguing archives, books and objects and research into the stories of the collection is essential in preparing the interpretation and conservation management plans for the historic boats. Assistance with collections care tasks such as cleaning, photographing and repacking fragile objects supports the museum in working towards Accreditation standards whilst assistance at events, open days and group visits enables us to open up the collection and welcome visitors to the Museum despite the undergoing redevelopment.

Volunteering across the Trust provides valuable opportunities to be a vital part of our exhibitions, activity and conservation programmes. Volunteers enable visitors to engage with our collections



in different ways whether it's through talks, demonstrations or simply just supporting events and in doing so become acquainted with a wide variety of different artists and art forms as well as learning about the heritage collections at Blackwell, the Museum of Lakeland Life or Windermere Steamboat Museum.

The Trust has worked with leading professionals and specialists in particular fields over the last year these have included Professor David Ingram, OBE, VMH, ScD, FRSE (Honorary Professor, Lancaster and Edinburgh Universities; formerly: Master, St Catharine's College, Cambridge), who wrote *The Flora of Blackwell* publication which describes the wealth of natural forms that feature in the decorative detail within Blackwell and also Hugh Wright to deliver a series of talks celebrating items of furniture in the Trust's collection. Hugh has written extensively about the work of Stanley Webb Davies and Arthur W Simpson.



Development

Windermere Steamboat Museum

An important focus for the Trust in 2012 was developing the plans for the Windermere Steamboat Museum in preparation for applying for planning consent and submitting the second round application to the Heritage Lottery Fund in spring 2013.

We selected Carmody Groarke architects and Arup engineers in November 2011 through an international competition run with the Royal Institute of British Architects and we completed the appointment of the design team at the start of 2012 with Real Studios interpretation planners and exhibition designers, Jonathan Cook landscape architects, Counterculture business planners and Turner and Townsend cost consultants and technical project managers.

During the year, with the support of a development grant from the Heritage Lottery Fund, we took the project to the detailed design stage, RIBA Stage D. In parallel with developing the designs, the Trust did extensive consultation to inform our plans. We developed the Conservation Management Plan to establish the conservation methodologies for the collection and the conservation approach for each vessel. Visitors to the Museum will be able to see the conservation workshop and learn about the traditional skills involved in restoring the boats.

The consultation particularly informed the Activity Plan for the Museum, which captures the broad range of learning and engagement activities that we plan to deliver as the project develops and in the completed Museum. We established the themes and content for the exhibition and interpretation at the Museum which will enable visitors to discover more about the collections, the people who built, owned and used the boats and the development of Windermere.

We made significant progress in 2012 towards reaching the match fundraising target for the Windermere Steamboat Museum. This included receiving generous private donations, grant offers from trusts and foundations, a conditional grant offer from the Regional

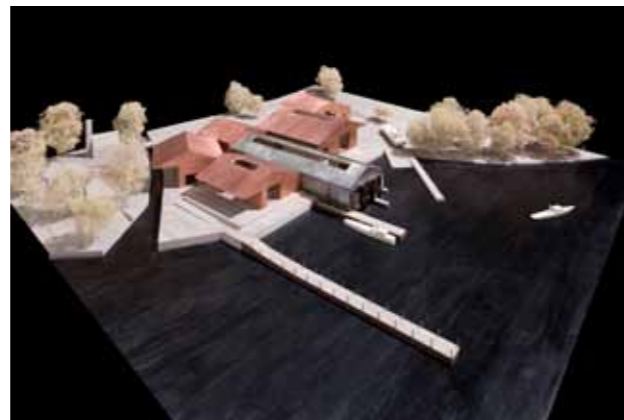
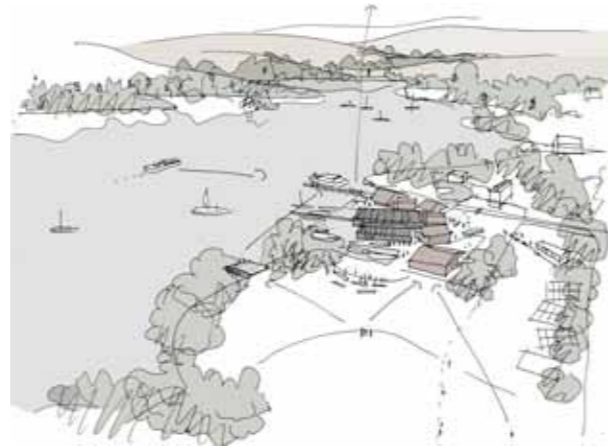

Growth Fund and funding from the Rural Development Programme for England. A list of major supporters for the capital project in 2012 is on page 21. In addition, we received funding for the conservation programme for SL Osprey.

Abbot Hall

With the support of The Monument Trust and the Sir John Fisher Foundation, we were able to develop the gallery shop at Abbot Hall. We now have a much better range of items for sale including books, greetings cards and souvenirs. A new addition is the wall of original artists' prints giving visitors the opportunity to buy works by leading contemporary artists. This is in addition to the selling shows in the Coffee House, which we refitted at the start of the year.

A successful application to Arts Council England's Grants for the Arts supported the organisational development study for Abbot Hall that we completed in the summer. The Trust worked with Counterculture strategic planners, Carmody Groarke architects and Jackson Coles cost consultants to produce a masterplan and outline designs for the Abbot Hall site and a sustainable business development plan.

Abbot Hall is a fine riverside villa built in 1759. It is a Grade 1 listed building in a stimulating location beside the River Kent, between Abbot Hall park and the medieval Holy Trinity church. The study showed the enormous potential of the site and the opportunities to improve the visitor experience and increase access to the Gallery and Museum collections.

We are excited by the outline designs which show how improvements within Abbot Hall could create high quality gallery spaces whilst retaining the eighteenth century proportions and feel. In addition, by moving facilities within the site, the whole area could become more animated and work as a lively, exciting space for exhibitions, displays and activities, enabling the Trust to show more of the collection and expand our activity programme.

We will use the study and master plan in applying for funding to develop Abbot Hall as the opportunities arise. We plan to do this in phases focused on improving the Gallery and Museum and improving spaces for learning, events, catering, storage and access to collections and information. A helpful step forward in 2012 was

Opposite
Windermere Steamboat Museum proposal
© Carmody Groarke architects

Below
Abbot Hall redevelopment proposal
© Carmody Groarke architects



the agreement by South Lakeland District Council in principle to extend the period and boundary of the lease.

Communication

Our external communication is focused on building and broadening the range of audiences who experience the Trust's activities. Our aim is to develop our current audiences and build new audiences.

The social web offers significant new opportunities for us to open ourselves up to a more diverse audience through relevant and stimulating content, initiating conversations and encouraging debate. All staff now have a voice through our Twitter site and through this give our followers a revealing insight into what we are doing and the many activities that we have to offer. The number of Twitter followers and people accessing digital content grew significantly in 2012.

We completely revised our website in 2011 and built on these changes in 2012. The new site is easy to navigate and has new content which is much more accessible. Much of our social media activity through Facebook and YouTube is aimed at driving traffic to our website.

The Trust's weekly e-newsletters reach over 2,500 subscribers; targeted editions also go to Friends of the Trust, teachers and supporters of the Windermere Steamboat Museum. They are an excellent way of promoting the events programme, and many of our events are now 'sold out'. Our 1,400 Friends, Patrons and Benefactors also receive quarterly postal mailings.

Press and PR

Our exhibition programme receives regular national media coverage. The *Turner and His Contemporaries* exhibition at Abbot Hall Art Gallery, for example, was covered by national BBC Radio, regional BBC television, five national newspapers and three specialist monthly magazines. Contemporary craft exhibitions at Blackwell are regularly featured in *Craft & Design*, and *Ceramics Review* magazines. We work closely with the local media who recognise the Trust as a key provider of cultural news and photo opportunities, resulting in almost weekly coverage in weekly and monthly publication.

Visitor research

We encourage feedback and added to the ways in which visitors can respond to visits in 2012, from online feedback forms to pick up feedback slips at each venue. In 2012 we also prepared for a major visitor research project in 2013 which will cover all the Lakeland Arts Trust sites as well as those of our partners in the Cumbria Museum Consortium, Tullie House Museum and Art Gallery in Carlisle and the Wordsworth Trust in Grasmere.

Catalogues

We publish catalogues with our main exhibitions, often designing and producing them in house. In 2012, the catalogues were: *Turner & his Contemporaries: The Hickman Bacon Watercolour Collection*, with essay by Tim Wilcox, *Francis Bacon to Paula Rego*, with essay by Robert Priseman, *Hughie O'Donoghue Vivid Field: Selected Paintings & Drawings 1984-2012*, with introduction by Colin Wiggins, in partnership with Marlborough Fine Art, London, *From Rossetti to Voysey: Arts & Crafts Stamped Cloth Book Cover Design*, with essay by Malcolm Haslam, *Light Structures: Halima Cassell*, with essay by Andrew Lambirth.

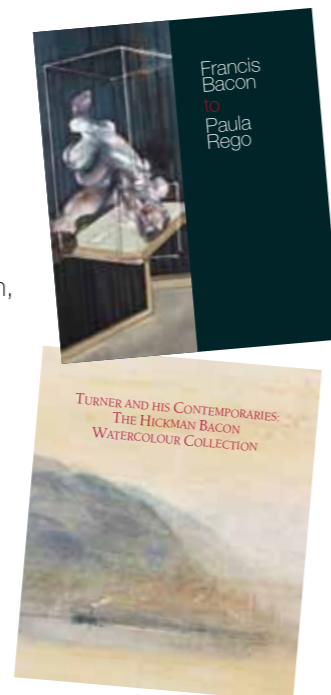

Catalogues are listed on our website- www.lakelandartstrust.org.uk and can be purchased from Abbot Hall and Blackwell shops or by telephoning 01539 722464

Commercial Activities

Below
Abbot Hall Art Gallery shop
Blackwell Tea Room
Blackwell Contemporary Craft Shop
© Lakeland Arts Trust



Fundraising

The Lakeland Arts Trust has been supported by voluntary donations since 1957 when Abbot Hall was redeveloped and reopened as an art gallery. Over 50 years later, the Trust now raises over 40% of its income from voluntary sources. These include trusts and foundations, individuals and the corporate sector. Our funders understand that in order to continue to conserve our Grade I listed buildings, care for and develop the Trust's permanent collections, promote world-class art and heritage and offer exciting programmes that involve local people, we must continue to raise income from these sources.

With support from the Arts Council England Catalyst Fund, the Trust is developing a strategy to increase its fundraising capacity and raise matched funding to ensure sustainability of the organisation. Catalyst funding is pound for pound matched funding to any fundraising from individuals, trusts and foundations and corporate giving.

In 2012 The Lakeland Arts Trust was supported by the following individuals and organisations:

Public Bodies

Arts Council England
Arts Council England: PRISM Fund Major Grants Programme
Arts Council England: Grants for the Arts
Arts Council England: Catalyst Arts
Heritage Lottery Fund Catalyst Endowments
South Lakeland District Council
South Lakeland District Council Cultural Olympiad
Kendal Town Council

Trusts and Foundations

The Monument Trust
The Erica Trust
L.D.A.G.A.M.T. Support Trust
The Headley Trust
The Sir John Fisher Foundation
The Prince's Foundation for Children & the Arts
Christie's
Rathbones Investment Management
Sanlam Private Investments

Westmorland Arts Trust
Pro Inside Track
Friends of Bradford Art Gallery
Rochdale Charitable Trust
Charles Hayward Foundation
Association for Industrial Archaeology
The Transport Trust
The Idlewild Trust
Gannett Foundation
North by North West
Craft Potters Association
Kendal Arts International

Individual donations

The Murray Family
J E Thompson

Benefactors

Mr & Mrs J Campbell
Lady Cavendish
Adam and Marianne Naylor
Mr T P Naylor
Mrs P Rink
Dr J P L Welch

Patrons

Mrs E Ainscough
Mr and Mrs T Ambler
Mr and Mrs C H Bagot
Mr O Barratt MBE and Mrs V Barratt
Mrs G Baxter
Miss M Burkett OBE
Mr J Borron
Mr and Mrs D Case
Lord Chorley
Mr and Mrs C Crewdson
Sir James Cropper KCVO
Mr and Mrs W Dufton
Miss R D Dunsmore
Lady Egremont
Mr and Mrs C R Ellins
Mr J Entwistle OBE
Mrs B A Fletcher
Mr and Mrs D Goeritz
Mr and Mrs J Graham
Dr M Guthrie
Mr T J R Harding
Mr R Hassell-McCosh
Ms J Holland
Mr and Mrs J Lee
The Hon. Sir Mark Lennox-Boyd

Mr N Mason
Mrs D Matthews JP
Mr J Merrett
Mr T Parker
Mr J S Rink
Mr K Schubert
Mrs H A Sandys
Mr and Mrs A Scott
Mrs A Shepherd
Mr and Mrs F Tattersall
Mrs S Thomely
Mr P M White
Mrs C Whittle
Ms J Wood
Mr and Mrs C Woodhouse
Mr N Woodhouse

Other funding

NbyNW (c/o The Harris Museum and Art Gallery)

In addition, during 2012 the Trust raised funds from the following sources for the redevelopment of the Windermere Steamboat Museum:

Heritage Lottery Fund
The Sir John Fisher Foundation
The Wolfson Foundation
Garfield Weston Foundation
Basil Samuel Charitable Trust
The Gosling Foundation
PF Fleming Charitable Trust
J Paul Getty Jnr Charitable Trust
Lindeth Charitable Trust
St Bega Charitable Trust
Rural Development Programme England (North West)
Regional Growth Fund

Mr and Mrs J S Rink
Mr A Meikle
Mr M Rayner
Brigadier John Wardle OBE DL
Mr E M Bottomley
Mr R Mallinson
Mr and Mrs P Hensman
Mrs S Tonge
Mr H Kippax
Anthony & Lady Elizabeth Leeming
Mr J Francis
Hutton in the Forest
Mrs M Cookson
Mrs G Baxter
Mr D Roberts

Mr J Stead
Lord Inglewood
Mr M Trelogan
Mr M Hopkinson
Mr B Whewell
Miss A Plint
Mr G Biddle
Dr I McGregor
Sir Christopher Audland
Mr C Laughton
Mr and Mrs J Bowers
Miss R Counsel
Mr J Cookson
Mr W Dufton
Mr I Hamilton-Burke
Dr J Walters
Mr D Jury
Mrs A Turnbull
Mrs S J Sinagola
Mr and Mrs S Read
Mr E M Astle
Ms A Smith and Ms C Shields
Mrs S Pattinson
Mr D Seex
Mr P Clark
Mrs A Morgan
Mr and Mrs D Barton
Mr M Blackburn
Mr M Applebee
Miss A Morrison
Mrs J Horsfield
Mr R Lomax
Mr J Swire
Mr P Hollins
Ms M Smith
Mr C Bell
Professor P Garside
Mr K Hilton
Mr J Nicoll
Mr C Slater
Mrs C Stevenson
Mr G Todd
Mr J Rayner
Sir James Cropper KCVO
Mr M Ainscough
Mr R Heise
Mr J M Robinson
Mr A Wade
Glasdon Limited
English Lakes Hotels

And those who wish to remain anonymous

Consolidated Statement of Financial Activities

(Including Income and Expenditure Account)

For the Year Ended 31 December 2012

	Unrestricted Funds	Restricted Funds	Restricted Endowment Funds	Total Funds 2012	Total Funds 2011
	£	£	£	£	£
INCOMING RESOURCES					
Incoming resources from generated funds					
<i>Voluntary income;</i>					
Grants, donations, bequests and sponsorship	352,152	329,259	0	681,411	468,322
Windermere Steamboat Museum Capital Project	0	449,678	0	449,678	108,110
<i>Activities for generating funds;</i>					
Commercial trading operations	364,716	0	0	364,716	359,485
Commission on sale or return items	41,050	0	0	41,050	37,940
Investment income	19,500	34,175	0	53,675	70,380
Incoming resources from charitable activities					
Admission charges	458,419	0	0	458,419	408,668
Education income	10,632	0	0	10,632	8,919
Other incoming resources					
	61,696	0	0	61,696	81,226
Total Incoming Resources	1,308,165	813,112	0	2,121,277	1,543,050
RESOURCES EXPENDED					
Cost of generating funds					
Cost of generating voluntary income	22,175	0	0	22,175	26,913
Fundraising trading; Commercial trading operations	391,784	0	0	391,784	369,353
Investment management costs	0	0	0	0	(576)
Charitable activities					
Cost of operating Art Gallery, Museums, Arts & Crafts House	817,081	330,714	0	1,147,795	987,680
Windermere Steamboat Museum Capital Project	137,377	374,480	0	511,857	114,702
Governance costs					
Cost of managing and administering the charity	66,958	0	0	66,958	86,883
Total Resources Expended	1,435,375	705,194	0	2,140,569	1,584,955
Net incoming/outgoing resources before transfers	(127,210)	107,918	0	(19,292)	(41,905)
OTHER RECOGNISED GAINS/LOSSES					
<i>Gains on revaluation of fixed assets:</i>					
Gains/losses on investment assets	3,070	0	76,701	79,771	(146,307)
Net Movement of Funds	(124,140)	107,918	76,701	60,479	(188,212)
RECONCILIATION OF FUNDS					
Fund balances as at 1st January 2012	523,449	125,249	1,464,602	2,113,300	2,301,512
Prior year adjustments	39,775	0	0	39,775	0
Fund balances as at 1st January 2012 as adjusted	563,224	125,249	1,464,602	2,153,075	2,301,512
Net movement in funds as above	(124,140)	107,918	76,701	60,479	(188,212)
Fund balances at 31st December 2012	439,084	233,167	1,541,303	2,213,554	2,113,300

Incoming Resources

- Core Funding from Arts Council England (North West)
- Patrons and Benefactors
- Windermere Steamboat Museum - Capital Project Funding
- Other Grants, donations, bequests and sponsorship
- Admissions and Gift Aid, excluding membership income
- Friends of the Trust
- Investment income
- Education activities, lectures and concerts
- Commercial trading
- Exhibition commissions, parking and other income

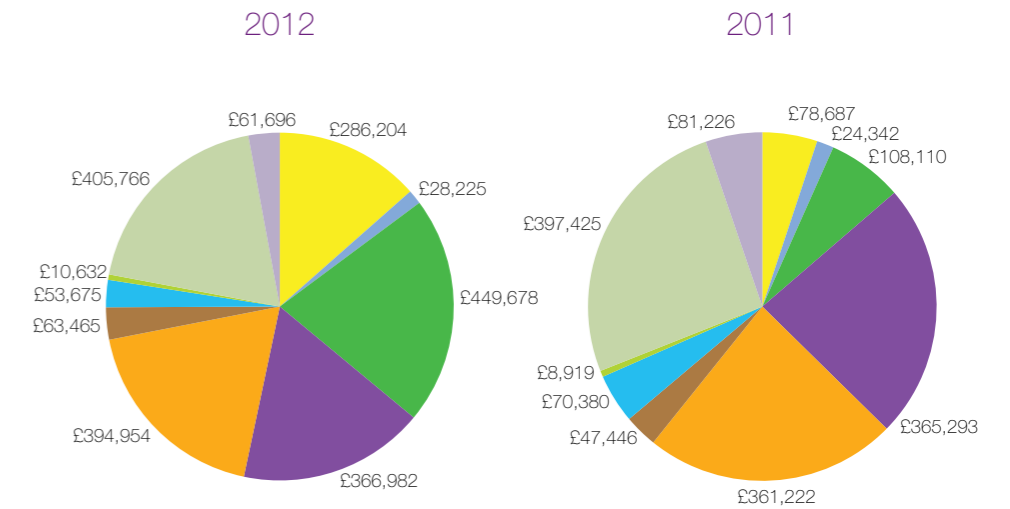

Resources Expended

- Cost of generating voluntary income
- Cost of operating Art Gallery, Museums, Arts & Crafts House
- Windermere Steamboat Museum - Capital Project Expenditure
- Investment management
- Commercial trading
- Governance

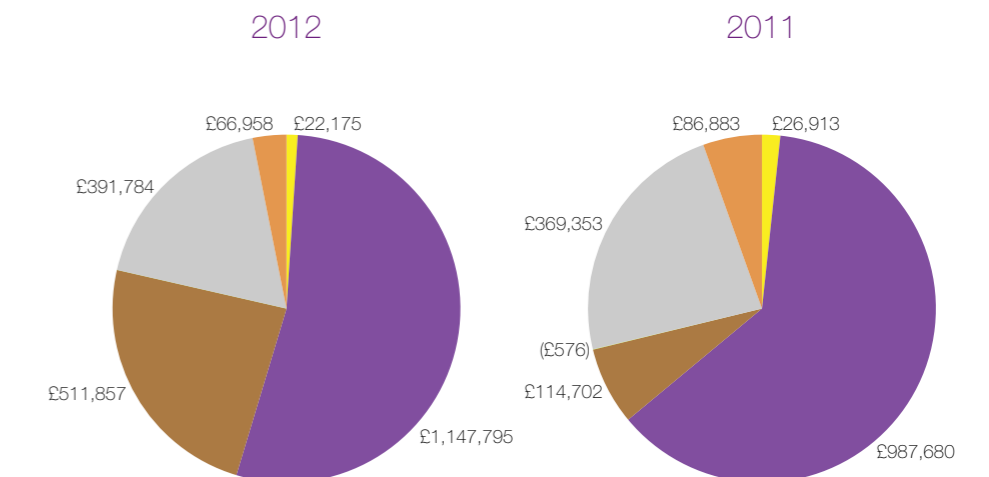



Designed and published by Lakeland Arts

www.lakelandartstrust.org.uk